

General

Our products are designed to comply with the recommended codes and practice, and is to be installed and serviced by competent persons in accordance with the relevant regulations.

Contents

The Smart Contact is supplied required batteries, magnet spacers and mount pack.

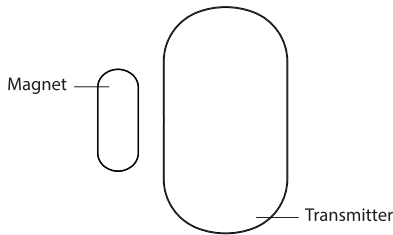

Magnet Spacer

There are 3 sized distance holders in the package. They can be stacked to allow for different distances.

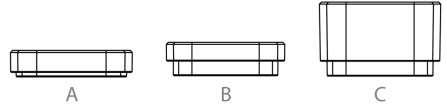

Heights(mm)	Holder
3	A
5	B
14.5	C
8	A+B
17.5	A+C
19.5	B+C
22.5	A+B+C

Installation

- Open the case and remove the battery activation strip.
- Mount the sensor on the door and the magnet on the door frame.
- Make sure the magnet is placed above that of the transmitter.
- Mount the magnet max. 10mm away from the transmitter, and secure the transmitter and magnet with tape or screws.
- Avoid mounting the sensor in areas with a large amount of metal or electrical wiring, such as a furnace or utility room.

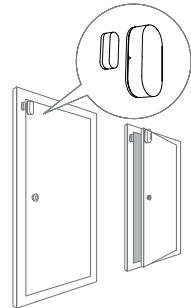

Guidance

- > Smart alarm accessories are specified at a maximum of 80 meters Line of Sight (LoS) in open air. For every obstacle the signal strength is reduced.
- > Battery life depends on working and environmental factors.

For more product information please visit the ESP website
For pairing instructions, please refer to the main Hub Manual.